

LOA	16.20 m 53'3"
Hull length	16.08 m 52'10"
LWL	14.60 m 47'11"
Beam	4.91 m 16'1"
Draft	2.80 m 9'2" (standard) 2.43 m 8' (option) 1.95 m 6'5" (option)
Displacement	approx. 18.7 t approx. 41,226 lb
Ballast	approx. 5.3 t approx. 11,700 lb
Engine	53 kW / 72 HP
Fresh water	approx. 700 l
Fuel tank	approx. 400 l
CE Certificate	A (ocean)
Mast length above WL	approx. 24.80 m approx. 81'4"
Total sail area	approx. 156.00 m ² approx. 1,679 sq ft
Main sail	approx. 87.00 m ² approx. 936 sq ft
Self-tacking jib	approx. 57.00 m ² approx. 613 sq ft
Genoa 105%	approx. 69.00 m ² approx. 743 sq ft (option)
Gennaker	approx. 195.00 m ² approx. 2,100 sq ft (option)
Rig	I: 21.25 m 70'11" J: 6.09 m 20'12" P: 20.95 m 68'7" E: 6.50 m 21'4"
Design	judel / vrollijk & co
Interior	HanseYachts Design

Model year 2010/2011 – valid from August 1st, 2010

STANDARD

OPTIONS

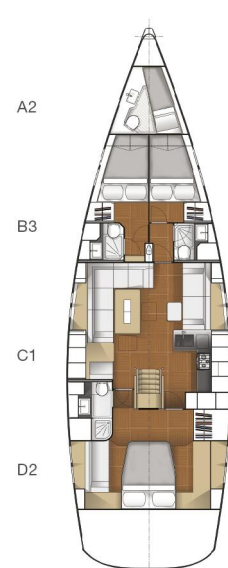
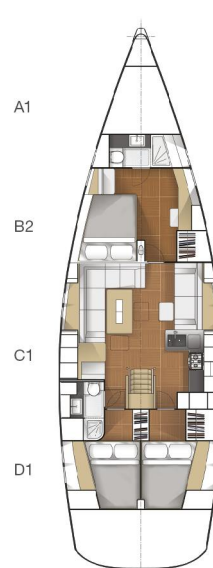
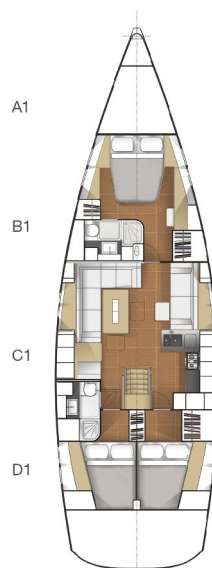
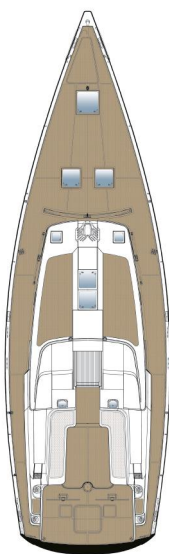

Hull

- White hull
- Dark grey double waterlines
- Options for different hull colours according to Hanse colour selection
- Isophthalic Gelcoat
- Vinylster for all outer laminates until the sandwich
- Polyester inner laminate (Orthophtalic or DCPD)
- Bulkheads laminated to hull and deck
- GRP strongbacks
- Hull windows

Deck

- White Deck with non slip structure
- Isophthalic Gelcoat
- Vinylster 1st layer
- Bulk laminate Polyester (Orthophtalic or DCPD)
- Balsa sandwich

Steering System

- Twin wheel steering system
- 2 leather covered steering wheels
- Semi-balanced, profiled rudder with alloy shaft and self-aligning needle bearings
- Emergency tiller

Keel

- Standard: T shape keel draft: 2.80 m / 9'2"
- Option: L shape composite iron / lead keel draft: 2.43 m / 8'
- Option: shallow draft keel, one piece fully lead 1.95 m / 6'5"
- Stainless steel keel bolts

Deck Equipment

- Teak on seats and cockpit floor
- Partial moulded non-skid surface on the coach roof and side decks
- Engine control at helm station stb
- 6 retractable mooring cleats
- Self-draining anchor locker with electrical windlass under deck
- Fix anchor arm with anchor roller
- Stainless steel cockpit table with acrylic glass and chart plotter bracket
- Foredeck sail storage with ladder and big hatch
- Hot & cold shower on aft deck
- Self-draining cockpit
- Halyard storage boxes in the cockpit
- Storage for gas bottle, selfdraining
- Stainless steel swim ladder
- Hinged swimming platform
- Self-tacking jib track, fully integrated in the foredeck
- Midboom sheeting with 2 stand-up blocks
- 2 x 6 sheave deck organizers
- 12 deck jammers
- 6x Padeyes for Gennaker, Jib
- 7 Flush hatches
- 2 hatches
- Special "Big Size" Opening portholes for aft Cabin in cockpit
- 4 opening side windows at coach roof
- Stainless steel pushpit with LED navigation light and ensign shaft socket
- Stainless steel split pulpit with LED navigation lights
- Stainless steel stanchions tapered
- Rail gates on both sides
- 4 winches in cockpit:
- 2 primary winches 54 AST
- 2 secondary winches 46 AST

Technical System**Plumbing System / Fresh Water****Tank**

- Fresh water tanks, capacity approx. 700 l
- Water infi II on deck

Hot water

- 40 l water heater, running from engine and immersion heater 230 V

Draining Pumps**Bilge pumps**

- 1 manual bilge pump
- 1 electric bilge pump with hose for compartments
- 1 electric bilge pump with automatic switch

Toilet / Head

- Manual marine toilets
- 1 holding tank with sea and deck discharge for each toilet

Engine

- Volvo D2-75, 53 kW / 72 HP, diesel engine, sail drive
- Option: Volvo D3-110, 78kW / 107 HP, diesel engine, shaft drive
- 3 bladed fixed propeller
- Fuel tank, capacity approx. 400 l
- Fuel infi I on deck
- Fuel filter / Water separator
- Engine room sound insulated and illuminated with room for (optional) generator above engine

Electric System

- 12 V and 110 V / 230 V

Batteries

- Main battery switches
- Engine battery: 12 V / 80 Ah AGM
- Service battery bank: 12 V / 300 Ah AGM

Battery charger / Shore power

- 230 V shore supply protected with differential breaker and distribution system
- Battery charge 50 A

Electric switch panel 110 V / 230 V

- Differential breakers
- Control gauges
- Voltmeter

Electric switch panel 12 V

- Switches for all onboard electrics
- Voltmeter and battery control(digital)
- Water / fuel gauges

12 V Electric equipment

- Electrical anchor windlass
- Pumps
- Navigation lights LED
- Interior lights
- Refrigerator

Outlet 230 V

- at chart table twin outlet
- in fwd. cabin one each
- in aft. cabin one each
- in galley twin outlet
- in saloon twin outlet
- in heads one each

Outlets 12 V

- at chart table
- at helm station

Interior lighting

- Overhead lighting in cabins, saloon, galley and heads
- Lighting in engine compartment
- Reading lights in saloon and cabins
- Night light on companion way
- Storage room aft

Navigation lights

- Navigation lights LED on pulpit and pushpit
- Steaming light LED
- Anchor light LED

Navigation instruments

- Compass illuminated
- Speedometer and depth sounder

Galley

- Solid surface, black quartz with integrated double sink
- 3-burner LPG stove with oven, gimble
- LPG Gas system
- Bottle storage in cockpit
- Extra large fridge of approx. 130 l, top and front loader with light
- Lockers and drawers
- Waste bin
- Option for microwave
- Option for fridge or freezer
- Option for coffee maker
- Option for dishwasher

Interior Accommodation

- High quality marine plywood, mahogany veneer, satin varnish
- Option: Cherry or beech veneer, satin varnish
- Option: high gloss finish
- White bulkheads
- Wooden door frames
- Wood / Sandwich doors
- Maple styled floor squares in the saloon, individually to be opened
- The optional pricelist shows an alternative floor to the standard

Upholstery

- According to Hanse colour selection

Sail Storage

- Version A 1 Foredeck sail storage with ladder and big hatch

Forward cabin

- Version B1 Owner cabin with island berth, extensive hanging lockers and drawers including a head and separate shower unit in owners state room
- Options according to Hanse Individual Cabin Concept

Main Saloon

- Version C 1
- Large saloon table
- Lockers
- L-shaped sofa on portside
- 2 seat lounge sofa on stb-side
- Options according to Hanse Individual Cabin Concept

Navigation area

- Seat with storage
- Locker above chart table for instruments and books
- Space to mount electronics
- 230 V / 12 V outlet
- Storage in the chart table
- Chart light

Aft cabin

- Version D1
- 2 double aft cabins with locker space
- Port side head and shower unit with big separate shower

Interior Concepts

- Different layouts, according to Hanse Individual Cabin Concept

Head / Shower

- Toilet and shower in forward cabin with toilet
- Toilet and shower in the aft cabin with manual toilet
- Corean™ solid surface black quartz with sink
- Electrical drain pump
- Mirror
- Locker & shelves
- Opening hatch

Rigg and Sails

- 3 spreader silver anodised mast, tapered
- Set of cruising sails
- Fully batten mainsail
- Self-tacking jib
- Boom with 2 reefing lines
- Cockpit light integrated in boom
- Furling system for jib under Deck
- Main halyard
- Jib halyard
- Midboom sheeting with 2 stand-up blocks
- Jib sheet
- Rod kicker
- Backstay adjuster